

# GRANT DUOWAVE CYLINDERS

**DUOWAVE200**  
**DUOWAVE250**  
**DUOWAVE300**  
**DUOWAVE400**

**WRAS**  
APPROVED  
PRODUCT



## **DUOWAVE FEATURES:**

**CLEAN MODERN DESIGN FOR  
CONTEMPORARY LIVING**

**DESIGNED FOR MINIMAL  
MAINTENANCE**

**HIGH FLOW RATES FOR  
POWERFUL SHOWERING**

**MANUFACTURED FROM CORROSION  
RESISTANT STAINLESS STEEL**

**PREMIUM CFC-FREE POLYURETHANE  
FOAM INSULATION**

**25-YEAR GUARANTEE ON THE  
STAINLESS STEEL CYLINDER SHELL**

**FOUR SIZES AVAILABLE RANGING  
FROM 200-400 LITRES**



**EFFICIENT HEATING SOLUTIONS**

## SOLAR CYLINDER DESIGN

Grant DuoWave Unvented Twin-Coil Cylinders are designed with both the consumer and installer in mind, to ensure optimum performance and reliability with minimal maintenance. The appliances are suitable for use with solar thermal systems or other applications where a secondary heat source is being utilised. Available in 200, 250, 300 and 400 litre sizes, the cylinders are ideal to provide hot water solutions for many types of domestic and small commercial properties and, at only 580mm in diameter, they are narrow enough to be sited in most standard airing cupboards.

All models are manufactured from high quality, corrosion resistant 316 stainless steel, ensuring a long life expectancy. The internal coils are constructed from 22mm diameter stainless steel, giving high efficiency as well as quick recovery. With the use of 40mm thick CFC-free, fire retardant polyurethane foam insulation, heat loss is kept to a minimum.

## SOLAR CYLINDER CONNECTION

Grant DuoWave Cylinders have two coils for connection to primary heat sources. Solar Thermal or another heat source should be connected to the bottom coil. The central heating boiler connections should be made to the top coil. In all cases, each coil must be connected using a 2 port motorised valve (for solar installations a high temperature valve must be used) to shut off the flow to the primary source and electrically interlocked with the heat source via the cylinder control and limit thermostat.

## SITING

Designed to be installed in a vertical position only, the cylinders can stand on any flat and level surface without special preparation, provided that it is capable of supporting the weight of the fully filled cylinder.

## TECHNICAL INFORMATION

Flow rates can be as much as 55 litres per minute at 2.1 bar (depending upon the incoming flow rate available). All cylinders have a maximum working pressure of 6 bar, but have been pressure tested to 10 bar. A minimum water supply of 20 litres per minute with a dynamic pressure of at least 1 bar is required.

Grant DuoWave Cylinders can be used safely on open vented systems. A minimum head of 1 metre must be maintained and will have a similar flow performance as an existing cylinder.

Each model is fully certified to the latest test procedures through WRAS.



## GENERAL INFORMATION

GRANT PRODUCT CODE	CYLINDER CAPACITY (LITRES)	DIMENSIONS		APPROX. WEIGHT	
		HEIGHT (MM)	DIAMETER (MM)	EMPTY (KG)	FULL (KG)
GDW200	200	1165	580	55	255
GDW250	250	1425	580	60	310
GDW300	300	1680	580	65	365
GDW400	400	2190	580	77	477



# VE CYLINDERS

## COMPONENTS SUPPLIED

Supplied with every cylinder are two control thermostats (which are adjustable between 45°C and 75°C) and an overheat thermostat for each coil, expansion vessel and flexi hose, 3kW low-level immersion heater (complete with control and overheat thermostats), tundish, non-return valve, pressure reducing valve and strainer, temperature and pressure relief valve (factory fitted) and cylinder drain cock.

ITEM	DESCRIPTION	SIZE
1	DHW Out	22mm
2	T & P Valve Pocket	3/4" BSPF
3	Boiler Return Tapping	22mm
4	Secondary Return Tapping	22mm
5	Boiler Control & Limit Thermostat Tapping	1/2" BSPF
6	Boiler Flow Tapping	22mm
7	2nd Heating Source Return Tapping	22mm
8	2nd Heating Source Control & Limit Thermostat Pocket (For Dual Stat only)	1/2" BSPF
9	Cold Mains In	22mm
10	2nd Heating Source Flow Tapping	22mm
11	Immersion Element c/w Control & Limit Thermostat Tapping	1 3/4" BSPF
12	Pressure Reducing Valve 3 bar	22mm
13	Balanced Cold Supply	22mm
14	Pressure Relief Valve 6 bar	22mm
15	T & P Valve 90°C/7 bar (factory fitted)	15mm
16	Tundish	-
17	Discharge Pipe (not supplied)	-
18	Mains Supply Pipe (not supplied)	-
19	Drain Cock	-

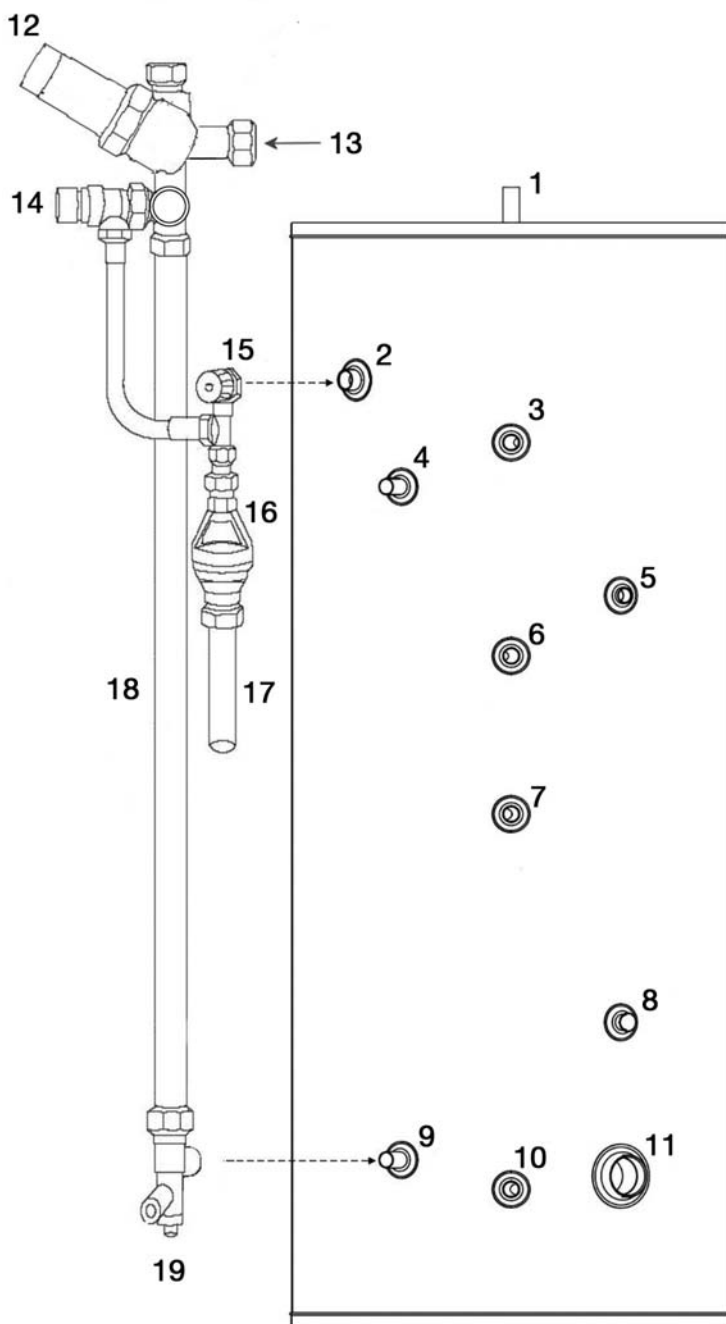

Note: The pipework between item 14 and 15 is not supplied.

## TECHNICAL SPECIFICATIONS

GRANT PRODUCT CODE	BOTTOM COIL PIPE					TOP COIL PIPE			
	LENGTH (M)	PIPE DIAMETER (MM)	SURFACE AREA (M <sup>2</sup> )	RECOVERY RATE (MINS)	COIL RATING (kW)	LENGTH (M)	PIPE DIAMETER (MM)	RECOVERY RATE (MINS)	COIL RATING (kW)
<b>GDW200</b>	11	22	0.76	24	12.1	8	22	10	8.8
<b>GDW250</b>	14	22	0.97	28	15.4	8	22	14	8.8
<b>GDW300</b>	16	22	1.11	27	17.6	8	22	18	8.8
<b>GDW400</b>	22	22	1.52	35	24.2	11	22	18	12.1

\*Recovery rate is based on 82°C flow at 0.2L/sec over a 50°C temperature rise for 70% of contents.

# FURTHER INFORMATION

## INSTALLATION

The installation of a Grant DuoWave Cylinder must be carried out by a competent person in accordance with the relevant requirements for safety, current Wiring Regulations, local Building Regulations, Building Standards in Scotland, Regulations and Bylaws of the local water Company and Health and Safety document No. 635 (Electricity at Work Regulations 1989). Comprehensive technical information can be found in the installation manual, which is supplied with every cylinder product.



## TRAINING ACADEMY

Grant's purpose-built Training Academy incorporates two air-conditioned lecture rooms, product training workshop, external tuition area, solar thermal installation area and refreshment facilities.

Grant now runs Logic Unvented Hot Water Certificate Courses, intended for plumbers and heating installers who wish to obtain the necessary qualification to allow them to install domestic unvented hot water systems in compliance with the Building Regulations G3 in England & Wales. The 1-Day course involves both theory and 'hands on' training, whilst the assessment involves both written and practical tasks.

## GUARANTEES

Grant DuoWave Cylinders have a full two-year component guarantee as well as a 25-year guarantee on the stainless steel cylinder shell, from the date of purchase. All guarantees are subject to being installed in accordance with the manufacturer's instructions and serviced on an annual basis. On completion of the installation, the system should be commissioned by a competent and the guarantee registration form returned to Grant UK.

## AFTER SALES SERVICE

For peace of mind, Grant DuoWave Cylinders are backed by a national network of service engineers. In the unlikely event of a problem occurring, your installer should telephone our customer service department on: **0870 7775553**

(This is not a premium number, calls are charged at a national rate)



## WEBSITE DOWNLOADS

For further information about the Grant product range or to download our brochures please key:

**[www.grantuk.com](http://www.grantuk.com)**

Our popular website is regularly updated with the latest news and product range developments.

This leaflet is accurate at the time of printing but as Grant has a policy of continual improvement it may be superseded. We reserve the right to amend specifications without prior notice. The statutory rights of the consumer are not affected.

All products manufactured under I.S. EN ISO 9001.

©Grant Vortex, Grant Solar, Grant DuoWave, Grant Aurora, Grant Sahara, Euroflame and Multi Pass are registered trade marks of Grant Engineering Limited. The contents of this leaflet are fully protected by copyright and nothing may be reproduced without permission from Grant.



**EFFICIENT HEATING SOLUTIONS**

**GRANT ENGINEERING (UK) LTD, HOPTON HOUSE, HOPTON INDUSTRIAL ESTATE  
DEVIZES, WILTSHIRE SN10 2EU TELEPHONE 0870 7775553 FAX 0870 7775559  
E-mail: [sales@grantuk.com](mailto:sales@grantuk.com) Website: [www.grantuk.com](http://www.grantuk.com)**